

-  Refer the Fixtures and Furnishings section of the DRM for details on Digital Signage.

Lighting Strategy

- Semi-recessed slot lighting system around the perimeter of the finish ceiling system to be used to create a soft front illumination on the fascia and customer side of the counter, and lengthwise along the walls of the adjacent spaces
- Adjustable recessed pot lights to be provided on the customer side in the bulkhead of the Service Counter
- Task eyeball lights provided at ceiling level on either side of the station attendant work area, with light direction concentrated at the centre of the attendant work surface, minimizing glare off desk surface
- Puck light at underside of station attendant counter for servicing with built in on/off controls
- 200mm cube pendant light above each station attendant service position to be individually programmed to indicate whether service position is open (ON), or closed (OFF)
 - This is an ambient light, not a task light. Consider placement of CCTV cameras to avoid conflict with pendant lights

Public Washrooms

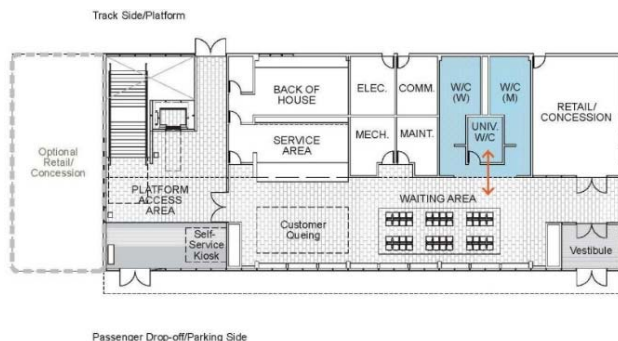

Figure E-9: Schematic of Public Washrooms

Design Requirements (In addition to all code requirements)

- Entrances into multi-use washrooms (i.e. female/male) shall be door-less
- All plumbing fixtures to be located on interior walls
- One standard infant change table/unit shall be provided in each washroom
- Floor drains shall not be in pedestrian or wheelchair paths
- The door swing into the universal washroom shall screen and partially obstruct the line of vision to the lavatory
 - It shall be equipped with a power operator
 - The door hardware shall be a lever handle passage set, with a latch operable from the interior, to display "vacant" or "occupied"
- An emergency two-way call system shall be provided and follow the same call flow as the two-way intercoms outside elevators (i.e. call directed to Station Attendant first, then Transit Safety, etc.)

Feature Elements

- Feature wall tile at Washroom entry to be different in colour from the general station wall finish
 - Use of smaller format tile with distinct pattern is supported
- Refer to Materials + Finishes Performance Specifications for additional information

Other Elements: Fixtures and Furnishings

- Partitions
- Lavatories (toilets/urinals), wall hung, lever handle faucets, wrist-blade type
- Sinks, wall-hung (barrier-free)
- Tilt mirrors, stainless steel frames (barrier-free)
- Electric Hand Dryers